

In order to install the Nuova Rade (47079, 44445, 195256, 195254) EURO Hatches, please follow the procedure described below.

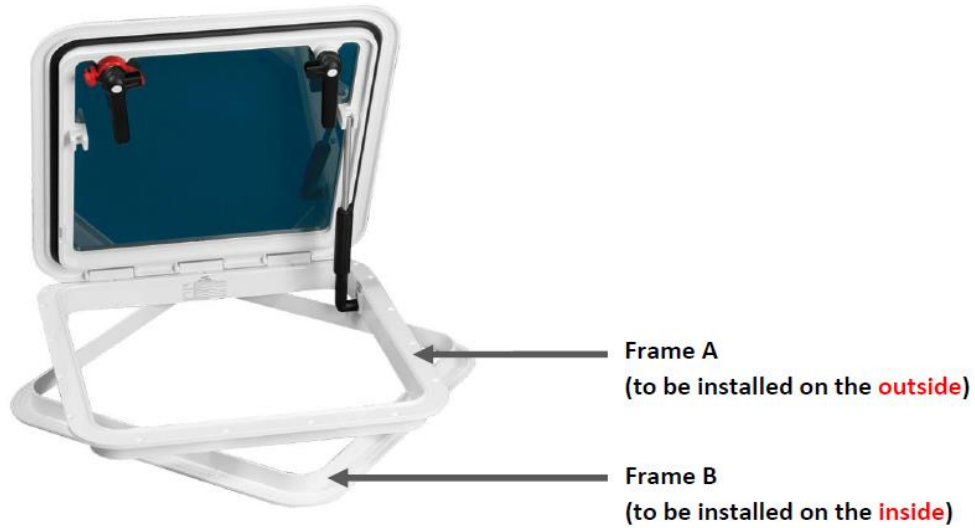

Picture 1

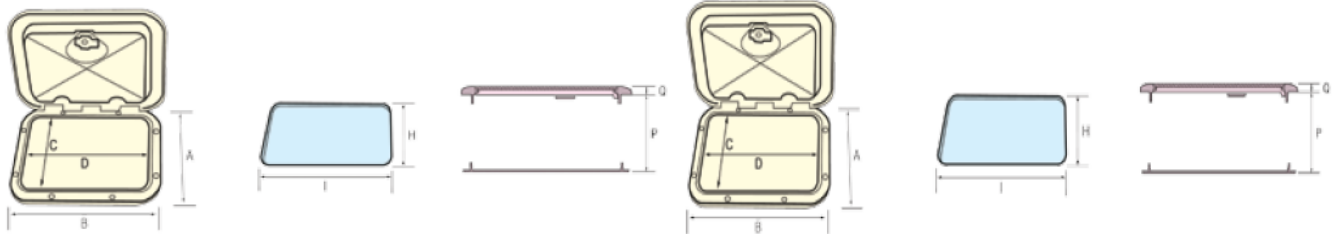

A (mm)	B (mm)	C (mm)	D (mm)	H (mm)	I (mm)	P (mm)	Q (mm)
268	448	196	376	209	389	25-55	22

Plexiglas Thickness: 8mm

Euro 1

A (mm)	B (mm)	C (mm)	D (mm)	H (mm)	I (mm)	P (mm)	Q (mm)
480	480	415	415	430	430	25-55	22

Plexiglas Thickness: 8mm

Euro 2

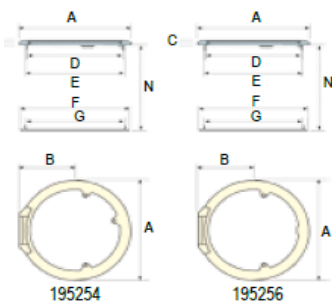

Code	A (mm)	B (mm)	C (mm)	D (mm)	E (mm)	F (mm)	G (mm)	N (mm)
195256	378	189	26	294	316	362	309	22.5-52.5
195254	590	294.5	27	506	518	574	521	22.5-52.5

Plexiglas Thickness: 8mm



Euro 38, 57

1. Make sure the area (seen as the pictures ahead depending on the relevant EURO hatch) where the hatch will be installed, is flat and its thickness is between 25-55mm for rectangular and 22.5-52.5mm for circular.
2. Cut the relevant opening (following the outline of the frames).
3. Mark the drilling points around the opening, according to the holes on the rim of frame A (defined in picture 1). The drill holes are $\Phi 6$ mm for Euro 1 & Euro 2 and $\Phi 5$ for Euro 38 & 57.
4. Drill the holes and apply silicon.
5. Attach frame B (defined in picture 1) to the inner rim of the opening as shown in picture 2.
6. Apply silicon and fasten frame A to the outer rim of the opening, as shown in picture 2.
7. Check for leakage and apply sealing if needed.

